

Daily Chair

Assembly Guide

Branch

The new way of working you've been waiting for.

Scan here for a digital copy
of your assembly guide.





Caution

- Use this product only for seating one person at a time.
- Some screws may be preassembled. If preassembled, ignore assembly instructions.
- Do not use this chair as a step stool/ladder, or on uneven floor surfaces.
- Do not sit on any part of the chair except the seat.
- Do not use chair unless all bolts, screws, and knobs are tightened.
- Every six months, please make sure all bolts, screws, and knobs are fully tightened to ensure stability.
- If any parts are missing, broken, damaged, or worn, stop use of the product until repairs are made using factory-authorized parts.
- Failure to follow these warnings could result in serious injury.

Components

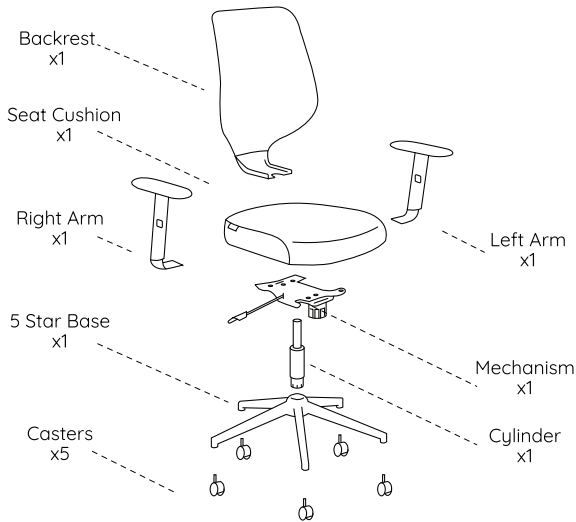

Backrest Screws
x4 (1.75")



Front
Mechanism Screws
x2 (1.25")



Mechanism &
Armrest Screws
x8 (1.0")



Washer
x14



Lock Washer
x4



Allen Key
x1

1

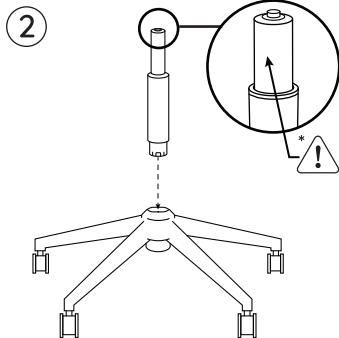
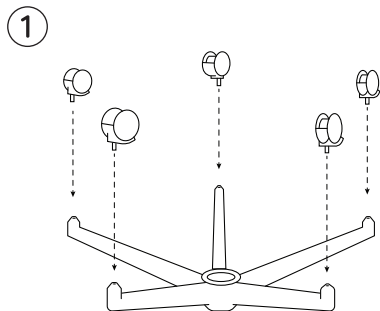

With the **5 Star Base** upside-down, push the **Casters** (x5) into each hole with a fair amount of force (they should 'pop' in). Once completed, turn over so the casters are on the floor and insert the **Cylinder** into the **5 Star Base** with the larger end on the bottom. Set the assembled base aside for now - we'll get back to it later!



* Caution: Handle the cylinder carefully as it may have grease on top, which can stain chair fabric or clothing.

2

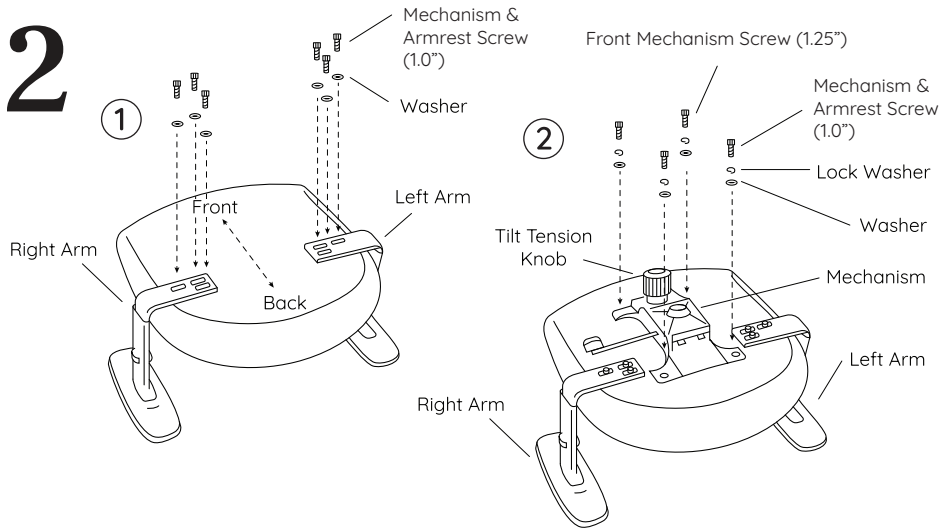

Align and attach the **Left and Right Arms** to the bottom of the **Seat Cushion**, taking note of the Front and Back of the Chair. Insert the 1.0" long **Mechanism & Armrest Screws** (x6) and **Washers** (x6) into the threaded holes in the bottom of the seat and tighten with the included **Allen Key**. Next, align the **Mechanism**, Tilt Tension Knob facing forward, and attach using the 1.0" long **Mechanism and Armrest Screws** (x2), the 1.25" long **Front Mechanism Screws** (x2), **Lock Washers** (x4), and **Washers** (x4). Screw tight with the **Allen Key**.

3

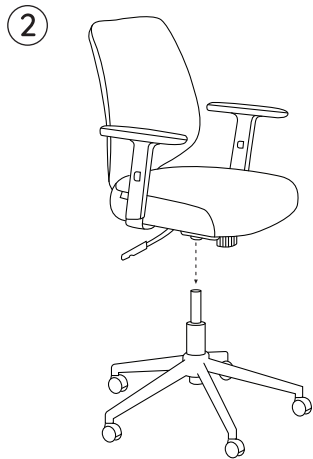
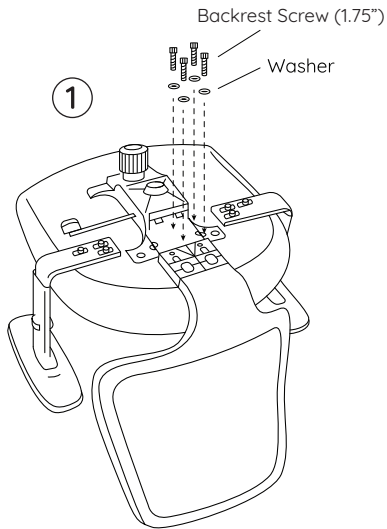

Attach the **Backrest** to the **Seat Cushion**. Insert the 1.75" long **Backrest Screws** (x4), **Washers** (x4), and screw tight with the **Allen Key**. Finally, turn the assembled seat upright and locate the center hole of the **Mechanism** over the **Cylinder**. Push down firmly until the connection is secure.

User Guide

Seat Height:

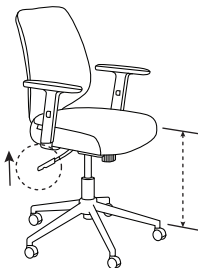

To raise:
While taking your weight off the chair, lift lever up.

To lower:
While seated, lift lever up.

Armrest Height:

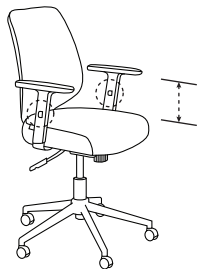

To adjust:
Push the button on the outside of each arm and move the arm up or down. Release the button to set the height.

Backrest Tilt & Lock:



To recline:
Pull the lever out to enable the tilt function. Push the lever in to lock in the upright position.

Tilt Tension



To adjust:
Rotate the knob located underneath the seat clockwise or counterclockwise to adjust the tilt tension to your preferred level of resistance.

Contact

Have a question, comment, or suggestion?

hello@branchfurniture.com
branchfurniture.com

Branch